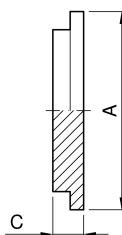

Fond d'écrou SMS

codice	DN	A	C	
	mm	mm	mm	kg
4.110.I9.11-B	25	35,5	7,5	0,06
4.110.I9.24-B	38	55	9	0,14
4.110.I9.44-B	51	65	9	0,22
4.110.I9.58-B	63	80	9	0,32
4.110.I9.70-B	76	93	10	0,53
4.110.I9.76-B	101	127	12	1,15
4.110.I9.77-B	104	118	12	1,15