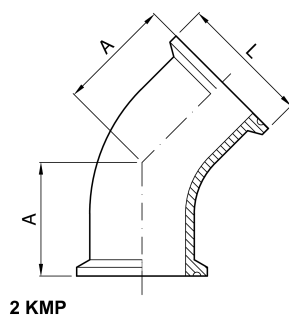

3A 45° elbow CLAMP ends

codice	DN	L	A	Peso
	inch	mm	mm	kg
4.480.LL.03-B	½	25,4	19,8	
4.480.LL.07-B	¾	25,4	24,6	
4.480.LL.11-B	1	50,4	28,5	
4.480.LL.24-B	1 ½	50,4	36,5	
4.480.LL.44-B	2	64	44,5	
4.480.LL.58-B	2 ½	77,4	52,3	
4.480.LL.70-B	3	90,9	60,3	

codice	DN	L	A	Peso
	inch	mm	mm	kg
4.480.LL.76-B	4	118,8	76,2	