

**Reduced thickness flange PN16**

Immagine  
momentaneamente  
non disponibile

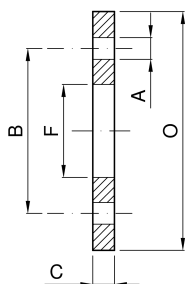

<b>codice</b>	<b>DN</b>	<b>F</b>	<b>A</b>	<b>B</b>	<b>C</b>	<b>O</b>	<b>fori n°</b>	
	<b>mm</b>	<b>mm</b>	<b>mm</b>	<b>mm</b>	<b>mm</b>	<b>mm</b>		<b>kg</b>
4.825.Z9.29-A	32	43	18	100	8	140	4	0,81
4.825.Z9.38-A	40	49/42	18	110	10	150	4	1,16
4.825.Z9.50-A	50	61,5/49	18	125	10	165	4	1,37
4.825.Z9.65-A	65	77/65	18	145	12	185	4	2,00
4.825.Z9.71-A	80	90/79	18	160	12	200	4/8	2,26
4.825.Z9.80-A	100	115,5/90	18	180	12	220	8	2,40
4.825.Z9.82-A	125	141	18	210	14	250	8	3,45

<b>codice</b>	<b>DN</b>	<b>F</b>	<b>A</b>	<b>B</b>	<b>C</b>	<b>O</b>	<b>fori n°</b>	
	<b>mm</b>	<b>mm</b>	<b>mm</b>	<b>mm</b>	<b>mm</b>	<b>mm</b>		<b>kg</b>