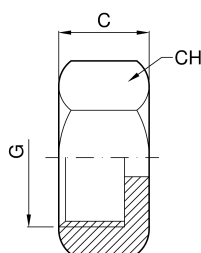

FEMALE BSP cap

codice	G	C	CH	
	inch	mm		kg
4.120.A9.04-Y	¼	17	15	0,02
4.120.A9.05-Y	⅜	16,5	19	0,04
4.120.A9.08-Y	½	19	25	0,05
4.120.A9.10-Y	¾	20	30,5	0,08
4.120.A9.13-Y	1	23	37	0,14
4.120.A9.29-Y	1 ¼	25,5	46,5	0,19
4.120.A9.38-Y	1 ½	25,5	53	0,26

codice	G	C	CH	
	inch	mm		kg
4.120.A9.50-Y	2	29	64,2	0,42
4.120.A9.65-Y	2 ½			
4.120.A9.71-Y	3			