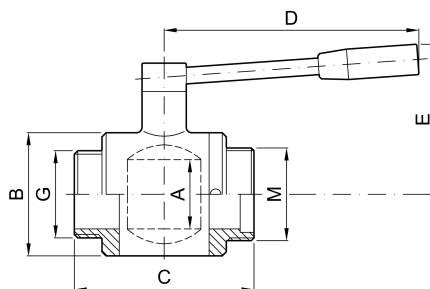

“CLASSIC” ball valve male GAS-MACON male ends

codice	MACON	G	A	M	B	C	D	E	
	mm	mm	mm	mm	mm	mm	inch	mm	kg
2.100.BQ.21-A	40	1	25	55	50	87	125	76	1,10
2.100.BQ.29-A	40	1 1/4	36	55	62	100	140	84	1,70
2.100.BQ.37-A	40	1 1/2	36	55	62	100	140	84	1,70
2.100.BQ.43-A	50	1 1/2	40	67	70	103	140	88	2,10
2.100.BQ.49-A	50	2	45	67	80	112	160	93	2,60
2.100.BQ.53-A	50	2	50	67	89	123	184	109	
2.100.BQ.60-A	60	2	57	79	101	134	184	115	4,30

codice	MACON	G	A	M	B	C	D	E	
	mm	mm	mm	mm	mm	mm	inch	mm	kg
2.100.BQ.68-A	70	21/2	66	90	114	152	215	126	6,30
2.100.BQ.74-A	80	3	80	102	140	182	245	148	9,80
2.100.BQ.79-A	100	4	100	125	161	204	275	161	14,40