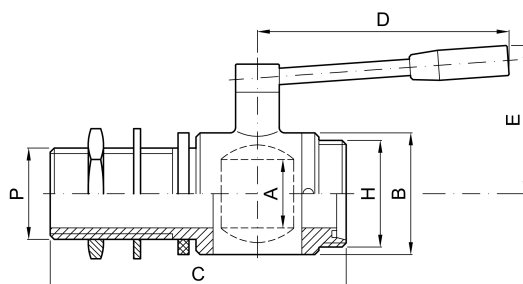

**“CLASSIC” ball valve for wood barrels - DIN end**

<b>codice</b>	<b>DIN</b>	<b>P</b>	<b>A</b>	<b>H</b>	<b>B</b>	<b>C</b>	<b>D</b>	<b>E</b>
	<b>mm</b>	<b>mm</b>	<b>mm</b>	<b>mm</b>	<b>mm</b>	<b>mm</b>	<b>mm</b>	<b>mm</b>
2.100.SD.32-A	40	42	36	65	62	*	140	84
2.100.SD.40-A	50	50	45	78	80	*	160	93
2.100.SD.50-A	60	60	50	85	89	*	184	109
2.100.SD.51-A	60	60	57	85	101	*	184	115
* su richiesta, on demand, sur request								