

“CLASSIC” ball valve DIN FEMALE-MALE ends

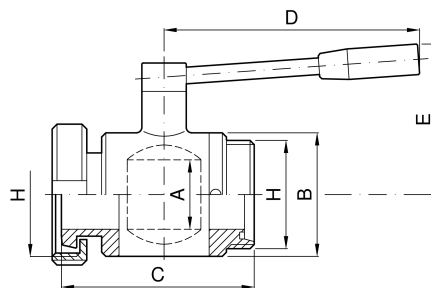

codice	DIN	H	A	B	C	D	E	
	mm	mm	mm	mm	mm	mm	mm	kg
2.100.ED.02-A	10	28	10	28	69	83	47	0,30
2.100.ED.06-A	15	34	15	35	76	83	50	0,40
2.100.ED.09-A	20	44	20	40	78	83	53	0,50
2.100.ED.12-A	25	52	25	50	93	125	76	1,10
2.100.ED.23-A	32	58	32	57	100	125	80	1,60
2.100.ED.32-A	40	65	36	62	105	140	84	1,75
2.100.ED.40-A	50	78	45	80	113	160	93	3,00

codice	DIN	H	A	B	C	D	E	
	mm	mm	mm	mm	mm	mm	mm	kg
2.100.ED.45-A	50	78	50	89	127	184	109	3,90
2.100.ED.51-A	60	85	57	101	141	184	115	4,60
2.100.ED.66-A	65	95	66	114	157	215	126	7,40
2.100.ED.72-A	80	110	80	140	188	245	148	10,70
2.100.ED.77-A	100	130	100	161	209	275	161	15,50