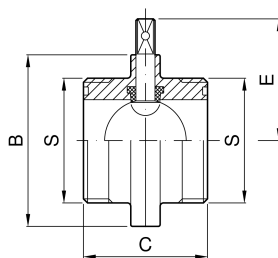

VALVOLA A FARFALLA CON ATTACCHI SMS FEMMINA-FEMMINA

codice	DN	S	B	C	E	
	mm	mm	mm	mm	mm	kg
1.100.HH.11-A	25	40	79	68	61,5	1,00
1.100.HH.24-A	38	60	85	76	68	1,25
1.100.HH.44-A	51	70	105	80	74,5	1,90
1.100.HH.58-A	63	85	113	82	78,5	2,10
1.100.HH.70-A	76	98	125	82	90,5	2,30
1.100.HH.76-A	101	132	157	88	100,5	4,00