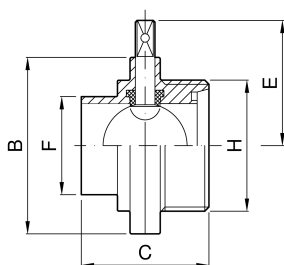

VALVOLA A FARFALLA CON ATTACCHI A SALDARE-DIN 11851 FEMMINA

codice	DIN	F	H	B	C	E	
	mm	mm	mm	mm	mm	mm	kg
1.100.FD.12-A	25	28	52	79	68	61,5	0,88
1.100.FD.23-A	32	34	58	85	72	64,5	1,05
1.100.FD.32-A	40	40	65	92	76	68,0	1,22
1.100.FD.45-A	50	52	78	105	78	74,5	1,65
1.100.FD.57-A	60	60	85	113	82	78,5	1,85
1.100.FD.66-A	65	70	95	125	79	84,5	2,00
1.100.FD.72-A	80	85	110	137	84	90,5	2,70

codice	DIN	F	H	B	C	E	
	mm	mm	mm	mm	mm	mm	kg
1.100.FD.76-A	100	101,6	130	157	88	100,5	3,35
1.100.FD.77-A	100	104	130	157	88	100,5	3,35