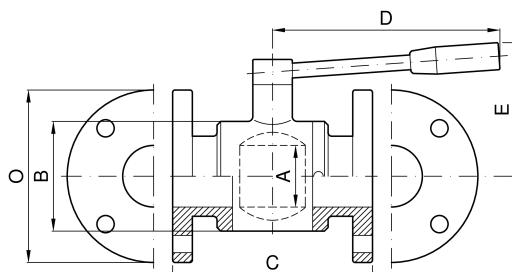

**VALVOLA A SFERA "CLASSIC" CON ATTACCHI FLANGIA PN 6-FLANGIA PN 6  
(UNI 2276)**

<b>codice</b>	<b>DN</b>	<b>G</b>	<b>O</b>	<b>A</b>	<b>B</b>	<b>C</b>	<b>D</b>	<b>E</b>	
	<b>mm</b>	<b>inch</b>	<b>mm</b>	<b>mm</b>	<b>mm</b>	<b>mm</b>	<b>mm</b>	<b>mm</b>	<b>kg</b>
2.100.XX.08-A	15	½	80	15	35	91	76	60	1,00
2.100.XX.10-A	20	¾	90	20	40	91	76	63	1,25
2.100.XX.13-A	25	1	100	25	50	107	106	83	1,60
2.100.XX.29-A	32	1 ¼	120	32	57	115	127	87	2,70
2.100.XX.38-A	40	1 ½	130	40	70	119	136	98	3,80
2.100.XX.50-A	50	2	140	50	91	139	160	113	4,90

<b>codice</b>	<b>DN</b>	<b>G</b>	<b>O</b>	<b>A</b>	<b>B</b>	<b>C</b>	<b>D</b>	<b>E</b>	
	<b>mm</b>	<b>inch</b>	<b>mm</b>	<b>mm</b>	<b>mm</b>	<b>mm</b>	<b>mm</b>	<b>mm</b>	<b>kg</b>
2.100.XX.65-A	65	2 ½	160	66	119	171	204	134	9,00
2.100.XX.71-A	80	3	190	80	140	201	261	168	13,50
2.100.XX.80-A	100	4	210	100	162	224	261	179	18,50