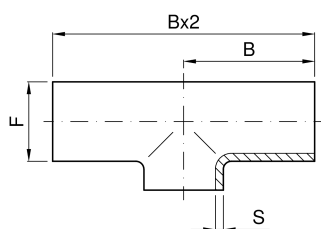

TEE "SBOCCATO" A SALDARE LUCIDO (PER TUBI DIN 11850)

codice	DN	F	S	B	
	mm	mm	mm	mm	kg
5.490.FF.12-B	25	28	1,5	50	0,10
5.490.FF.23-B	32	34	1,5	55	0,13
5.490.FF.32-B	40	40	1,5	60	0,18
5.490.FF.45-B	50	52	1,5	70	0,22
5.490.FF.57-B	60	60	1,5	75	0,53
5.490.FF.66-B	65	70	2	80	0,80
5.490.FF.72-B	80	85	2	100	1,40

codice	DN	F	S	B	
	mm	mm	mm	mm	kg
5.490.FF.76-B	100	101,6	2	100	1,40
5.490.FF.77-B	100	104	2	100	1,45
5.490.FF.81-B	125	129	2	187	
5.490.FF.86-B	150	154	2	225	
5.490.FF.90-B	200	204	2	178	