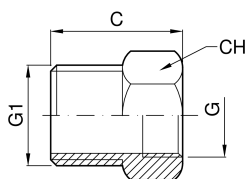

RIDUZIONE ESAGONALE GAS MASCHIO - FEMMINA (ISO 4144)

codice	G1	G	C	CH
	inch	inch	mm	
4.290.BA.04-Y	1/4	1/8	14,5	14,5
4.290.BA.05-Y	3/8	1/4	16	18
4.290.BA.08-Y	1/2	3/8	19,5	22
4.290.BA.10-Y	3/4	1/2	21	28
4.290.BA.13-Y	1	3/4	24	35
4.290.BA.29-Y	1 1/4	1	27	43,5
4.290.BA.38-Y	1 1/2	1 1/4	27	49,5

codice	G1	G	C	CH
	inch	inch	mm	
4.290.BA.50-Y	2	1 ½	32	62
4.290.BA.65-Y	2 ½	2		
4.290.BA.71-Y	3	2 ½		
4.291.BA.08-Y	½	¼	19,5	22
4.291.BA.10-Y	¾	⅜	21	28
4.291.BA.13-Y	1	½	24	35
4.291.BA.29-Y	1 ¼	¾	27	43,5
4.291.BA.38-Y	1 ½	1	27	49,5
4.291.BA.50-Y	2	1 ¼	32	62